

## Installation Manual and Operating Instructions

..... BB-800, 900, 1000

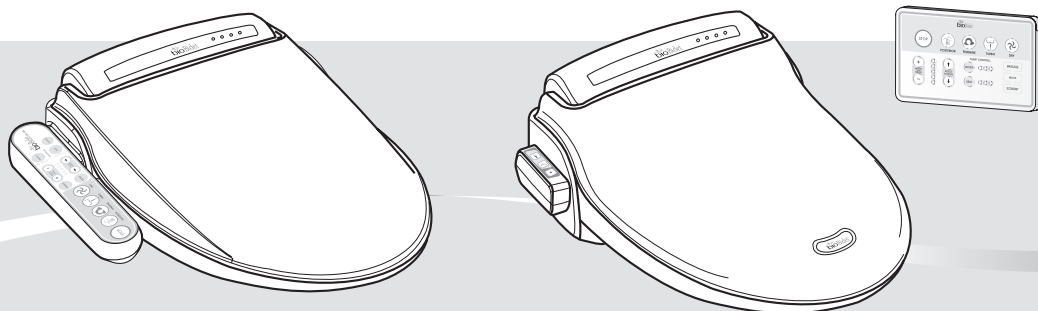

### Safety instruction

1. This appliance is not intended for use by persons (including children) with reduced physical, sensory or mental capabilities, or lack of experience and knowledge, unless they have been given supervision or instruction concerning use of the appliance by a person responsible for their safety.
2. Children should be supervised to ensure that they do not play with the appliance.
3. If the supply cord is damaged, it must be replaced by the manufacturer, its service agent or similarly qualified persons in order to avoid a hazard.
4. The new hose-sets supplied with the appliance are to be used and the old hose-sets should not be reused.

### -Warning symbols comment:



Do not sit on lid



Do not stand on lid

- This Product should be installed according to this manual.
- Please read this manual carefully and install properly.
- Please keep this manual for future reference.
- Please register Warranty for proper service.

# Contents

▪ IMPORTANT SAFEGUARDS / .....	4
GENERAL CAUTIONS	
▪ CAUTIONS BEFORE INSTALLATION .....	7
▪ CARTON CONTENTS / IDENTIFICATION.....	8

▪ OPERATION (BASIC) .....	9
▪ OPERATION (DETAILS) .....	10

▪ INSTALLATION .....	14
▪ SEPARATION OF THE UNIT FROM THE TOILET BOWL .....	17

▪ MAINTENANCE .....	18
▪ WATER DRAINING .....	19
▪ TROUBLE SHOOTING .....	20
▪ SPECIFICATIONS .....	21
▪ WARRANTY .....	22
▪ INFORMATION TO THE USER .....	23

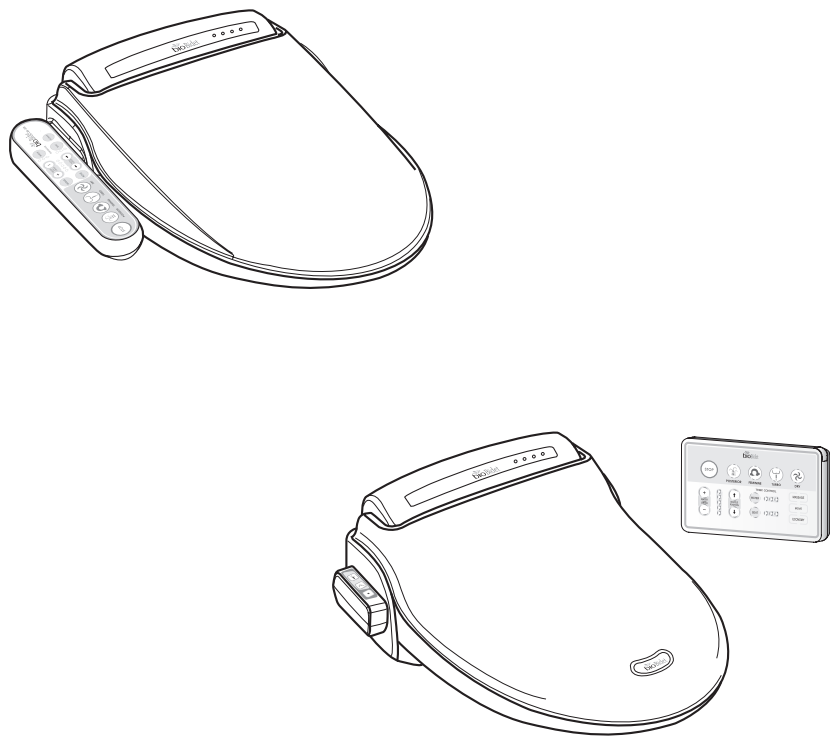

Thank you for purchasing The Bio Bidet Electronic Bidet Toilet Seat  
This unit was manufactured for household use.

PREPARATION

OPERATION

INSTALLATION

MAINTENANCE

1 IMPORTANT SAFEGUARDS / GENERAL CAUTIONS

● READ ALL INSTRUCTIONS BEFORE INSTALLATION AND USE

The following terms are used in this manual to indicate hazards of varying degrees of severity

DANGER	Indicates an imminently hazardous situation which, if not avoided, will result in death or serious injury.
WARNING	Indicates potentially hazardous situation which, if not avoided, could result in death or serious injury.
CAUTION	Indicates potentially hazardous situation which, if not avoided, may result in minor or moderate injury or in damage to the product or other property.

- 

DANGER – To reduce the risk of electrocution
- 

WARNING – To reduce the risk of burns, electrocution, fire or injury to persons
- 

PLEASE OBSERVE THE FOLLOWING PRECAUTION BEFORE USING THIS PRODUCT



Do not dismantle

Do not open the product to repair or remodel.  
Only qualified service personnel should service this product.  
Do not use attachments not recommended by the manufacturer.



Prohibited

Connect the product to cold water supply pipe carrying potable water.  
Do not connect to an industrial water supply line that does not carry water of drinking quality as this will negatively affect hygiene and performance.

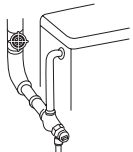

Prohibited

**About Low Temperature Burns–**  
A burn occurs when the skin has been exposed to high temperatures. However, a low temperature burn may occur when the skin has been in contact with an object at relatively low temperature (about 104 °F/40°C). Close supervision is necessary when this product is used by children or people with sensitive skin.



Prohibited

If using any chemical toilet bowl cleaner, be sure to wipe up any spills that splash onto The Electric Bidet. Do not use benzene or any acid chemical detergent. Only neutral detergent permitted.



Prohibited

Do not plug in the power cord before connecting the water supply hose.

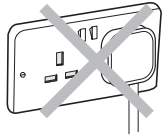

Earthing

This product must be earthed.  
An approved residual current device(RCD) must be used.



Do not spray water

Do not splash water on this product. Please provide adequate ventilation to avoid damage to electronic components due to high level of humidity. It is necessary to provide adequate ventilation with a fan, open door or open window when bathing.

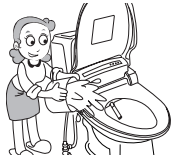

Wet hands prohibited

Do not touch the power cord with wet hands.  
Do not reach for a product that has fallen into water.  
Unplug immediately!

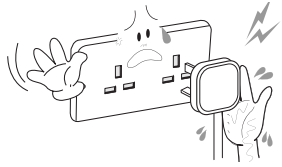

Observe at all times

This product must be connected to a standard voltage power source. Do not connect power cord if the cord is damaged or broken. Do not plug the unit into a loose electric outlet.

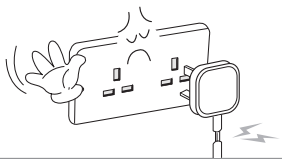

Observe at all times

Please disconnect the power cord when you clean this product or detach it from toilet bowl. Do not supply electrical power to the unit until the plumbing work has been completed.

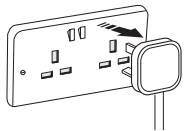

Use of fire prohibited

Keep the electrical cord away from heated surfaces to prevent a fire hazard. Also, keep any flammable materials away from this product at all times.



## CAUTION



Prohibited

Never operate this product if it is not working properly, if it has been dropped or damaged, or dropped into water. Return the product to a service centre for examination and repair



Prohibited

Do not obstruct or put anything into the dry air outlet. Do not apply excessive force to the shower nozzle.



Prohibited

Do not stand or sit on the seat lid. It is not designed to support a user's body weight.



Prohibited

Allow the seat and lid to close automatically; do not force the seat and lid.



Prohibited

Do not strain or push the connected hose and tube connector; it may cause water leakage. Never drop or insert any object into any opening or hose. Use proper plumbing supplies if any modification is to be made.

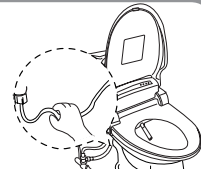

Observe at all times

Use this product only as described in the operating instructions. Never use while sleeping or drowsy. Do not use while bathing.



Observe at all times

Be careful so that this product does not become stained with excrement and urine.



Observe at all times

Drain the water from the unit and switch off the power if it is not going to be used for an extended period of time. Refer to page 19.

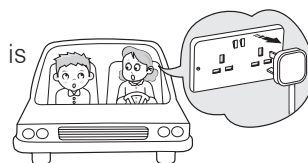

- SAVE THESE INSTRUCTIONS -

## 2

## CAUTIONS BEFORE INSTALLATION

### WIRING REQUIREMENT

This product is supplied with a three-pin earthing plug complying with BS 1363 which must be plugged into a three pin earthed power socket(220–240V AC, 50–60Hz) and protected by a residual current device(RCD). The rated power consumption is 600–700W.

If this product is used in a bathroom or shower room, the supplied plug must be cut off and the connection to the power supply must be made via a switched fused spur and RCD. No other appliance should share the spur with this product.

The work must be carried out by a qualified electrician.

The use of an extension cord is not recommended. If it is necessary to use an extension cord, use only a three-pin extension cord incorporating a RCD and a socket that will accept the plug on this product. The marked rating of the extension cord should be equal to or greater than the rating of this unit(10amp)

Consult a qualified electrician if you are unsure whether the unit is properly earthed.

If repair of the cord or replacement of the plug is necessary, this should only be carried out by a competent person using a plug complying with BS 1363.

If in any doubt about the correct wiring of the plug, an electrician should be consulted.

The manufacturer and distributor cannot be held responsible for damage or injury resulting from the use of this product on other than specified voltage or without proper earthing.



**WARNING : This appliance must be earthed.**

Improper earthing can result in a risk of electric shock. Electric wiring must be done in accordance with all local and national codes.

### OPTIONAL ADDITIONAL EARTHING INSTRUCTIONS

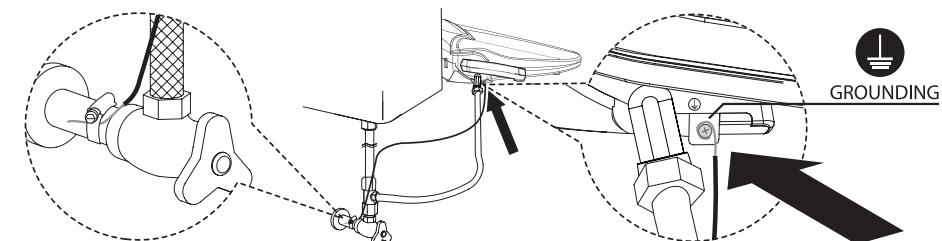



3 IDENTIFICATION

1 MAIN UNIT

BB-800, 900

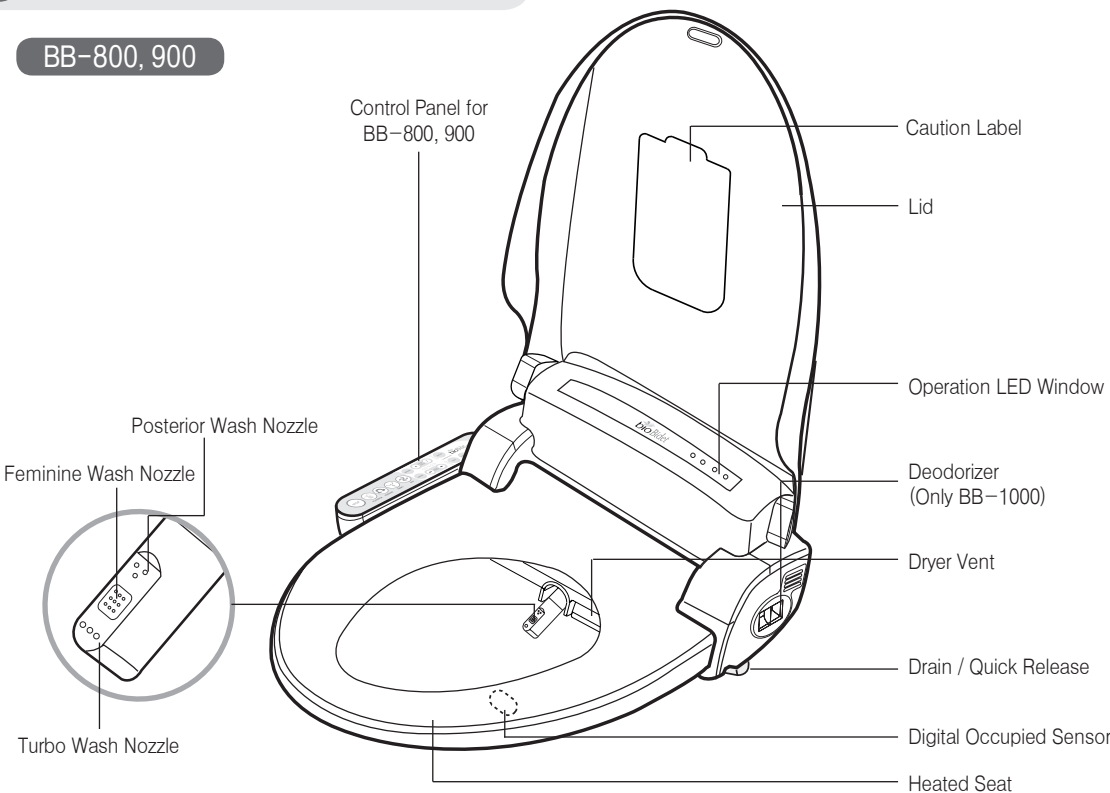

BB-1000

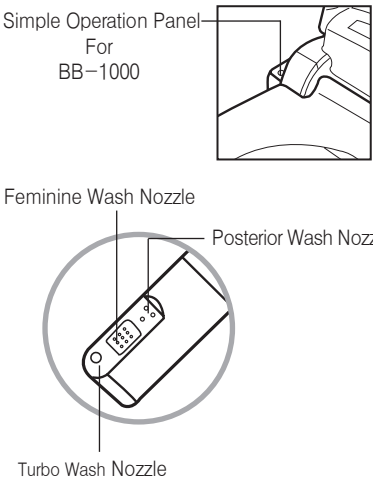

2 ACCESSORIES

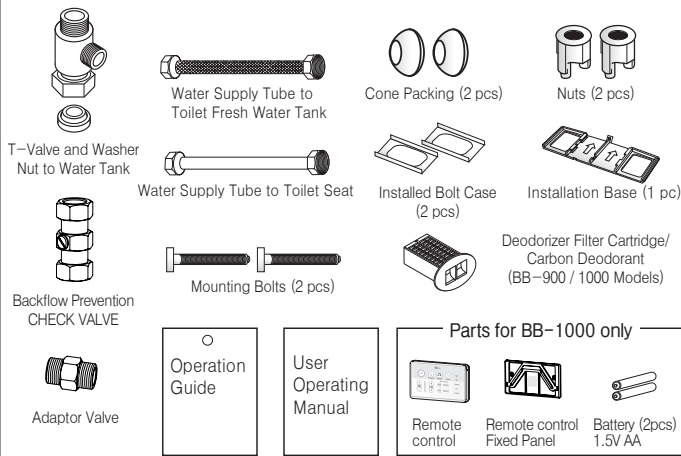

4 OPERATION (BASIC)

BB-800, 900 Control Panel

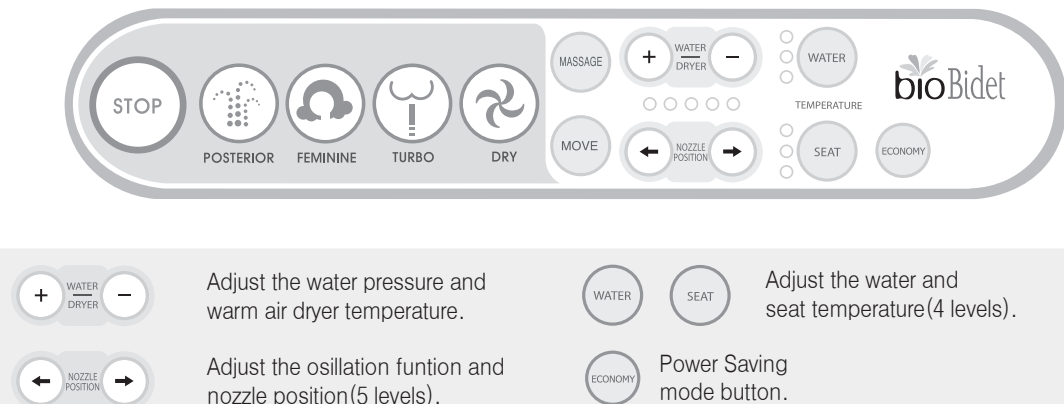

BB-1000 Remote Control

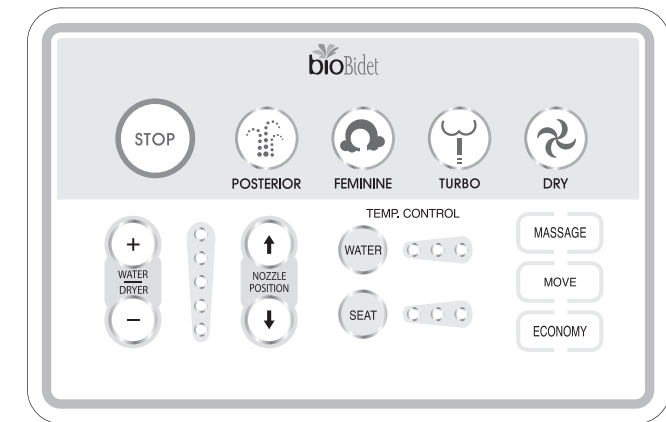

Simple Operation Panel

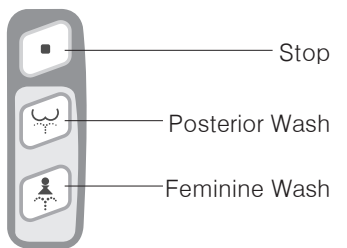

- When you sit on the seat, please sit down on the central position in order to activate the sensor.
- After an extended wash, allow about three minutes for water to reheat.

## 5 OPERATION (DETAILS)

### 1 PREPARATION

- Check for any water leaks.
- Plug the unit into the proper power source and the LED power light will start flashing.
- Wait until the LED power light stops flashing and becomes solid red.
- The water tank will be filled after pressing a “Wash” (🚿 or 🌀) button.
- When the water tank is filling the buzzer “Beeps” continuously.  
After the water tank is full the buzzer will end with “One Solid Beep”.

### 2 OPERATION

#### • SIT ON THE SEAT

- When you sit on the seat, the digital sensor on the seat is activated and the ORANGE LED lamp on the main unit indicating “Occupied sensor” will light up.
- Simultaneously the Deodorizer fan will start working. (BB-900 / 1000 Models)
- See page 11 for details about changing the seat or water temperature.

#### • STOP

- Press this button to stop all operation.

#### • CLEANSING

##### • CLEANSING 1. (Posterior Wash) 🚿

- 1- Press “Posterior” (🚿). The nozzle comes out and sprays warm water to posterior.
- 2- Additional functions during Posterior Wash are available. See Oscillation, pg.12 and Massage, pg. 13 for details.

##### • CLEANSING 2. (Feminine Wash) 🌀

- 1- Press “Feminine” (🌀). The nozzle comes out and sprays warm water to feminine area.
- 2- Additional functions during Feminine Wash are available. See Oscillation, pg.12 and Massage, pg. 13 for details.

##### • CLEANSING 3. (Turbo Wash) ⚠️

- 1- Press “Turbo Wash” (⚠️). The nozzle spray is more focused to produce the effect a strong wash, to help stimulate bowel movement.
- 2- Press “+ / -” button to adjust the water pressure.



Observe at all times

### CAUTION

DO NOT ALLOW CHILDREN TO USE THE **TURBO WASH** FUNCTION!  
SUPERVISION IS STRONGLY RECOMMENDED FOR THE ELDERLY OR OTHER PERSONS THAT MAY HAVE LIMITATIONS IN BODY MOVEMENT, ILLNESS OR DISABILITIES!

#### • CLEANSING cont.

##### • CLEANSING 3. (Turbo Wash) ⚠️

- 1- Press “Turbo Wash”, The water nozzle comes out and sprays a concentrated stream of water to the posterior.
- 2- If necessary, adjust “Position” of water stream with the (↑ / ↓) buttons.
- 3- Press “+ / -” button to adjust the water pressure as desired.
- 4- Press the “STOP” (⏹️) button when you feel your abdomen is full or wait until the “Turbo Wash” function stops. (approximately 1 minute.)
- 5- You will shortly feel the urge to push the water out of your colon, push the water and feces out as completely as you can.
- 6- Relax for a few minutes and be sure you feel your colon is empty and then use the “Posterior Wash” and “Air Dry” function to finish.

#### • WARM AIR DRYER

- 1- Press “Dry” (🌀), warm dry air is gently directed to washed area for about 3 minutes.
- 2- You may adjust the warm air temperature by pressing High (+) and Low (-) buttons.

※This product memorizes the air temperature of prior use.

#### • WATER PRESSURE ADJUSTMENT

- After sitting down on the seat, the LED lamp (●●●●●) for water pressure on the Power Control will light at third or middle level (●●●●●)
- Press high (+), or low (-) to adjust the pressure of the water spray to your desired comfort level

#### • WARM WATER TEMPERATURE AND SEAT TEMPERATURE ADJUSTMENT

- The temperature of water and seat are adjustable to the desired level by pressing the “WATER” (🚿) and “SEAT” (🪑) button.

WATER TEMPERATURE

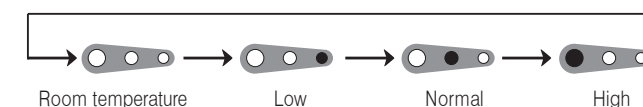

SEAT TEMPERATURE

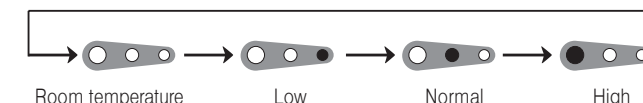

## 5 OPERATION (DETAILS)

### • NOZZLE POSITION ADJUSTMENT

- Nozzle position is adjustable to the desired position by pressing “Front” (↑) or “Rear” (↓) button from 1 to 5 positions.  
When selecting a wash cycle the nozzle will extend to its last used position.

### • DEODORIZER

(BB-900, 1000 Models)

- The deodorizer fan is activated when the seat is occupied.  
When finished, the fan will stop after 1 minute.
- Air current for the deodorizer has 4 adjustable levels. While pressing the “STOP” (STOP) button, press the “WATER” (WATER) button to the desired air current level. See diagram:

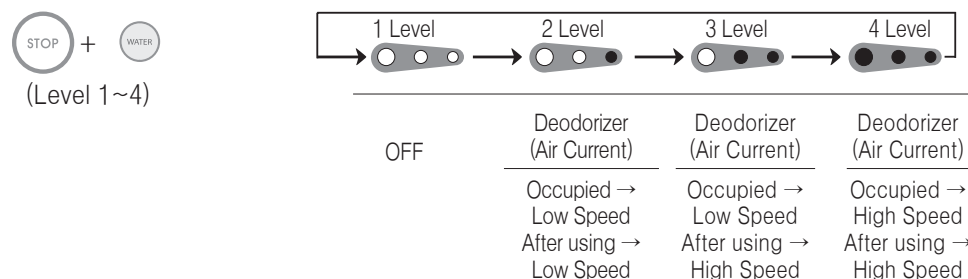

### • OSCILLATION (Nozzle Movement Function)

- When using Posterior or Feminine Washing functions, pressing the “MOVE” (MOVE, MOVE) button will provide a short-motion, front to back oscillating spray for a much wider cleansing effect. Note: This function will not work during the “Turbo Wash” function.
- You may change the position of the Oscillating spray by pressing the “Front” (↑) or “Rear” (↓) button.
- Push the “MOVE” (MOVE, MOVE) button again and the oscillation motion will stop automatically.

#### Auto-Setting of Oscillation Feature

- You can set this function to automatically oscillate whenever the seat is occupied and the Posterior or Feminine washes are in operation.
- Without sitting on the seat, press
- The “MOVE” (MOVE, MOVE) button for 3 seconds or until you hear a single Chime.
- Sit on the seat and proceed with Posterior or Feminine Wash.

**Note:** In the automatic setting, you may still adjust the position of the Oscillating spray by pressing the “Front” (↑) or “Rear” (↓) buttons.

#### Canceling the Automatic Oscillation function

- Without sitting on the seat, press
- The “MOVE” (MOVE, MOVE) button for 3 seconds or until you hear a double Chime.

### • MESSAGE (Rhythm Wash)

- When using any of the wash programs pressing the “MESSAGE” (MESSAGE, MESSAGE) button will provide a pulsating spray.
- You may change the pressure of the spray by pressing the “High” (+) button or “Low” (-) button.
- Push the “MESSAGE” (MESSAGE, MESSAGE) button again and the pulsating action will stop automatically.

#### Auto-Setting of Message Feature

- You can set this function to automatically pulsate whenever the seat is occupied and any of the wash programs is in operation.
- Without sitting on the seat, press
- The “MESSAGE” (MESSAGE, MESSAGE) button for 3 seconds or until you hear a single Chime.
- Sit on the seat and proceed with the wash program.

**Note:** In the automatic setting, you may still adjust the pressure of the pulsating spray by pressing the “high” (+) or “low” (-) buttons.

#### Canceling the Automatic Oscillation function

- Without sitting on the seat, press
- The “MESSAGE” (MESSAGE, MESSAGE) button for 3 seconds or until you hear a double Chime.

### • ECONOMY (Energy Save Mode)

- The ENERGY SAVER is not on when the LED light is off.
- Press button once to choose “ECONOMY 1”
- Press button again to choose “ECONOMY 2”
- Press button third time to turn “ECONOMY” off

\* ECONOMY 1 : the water temperature will be kept at 90°F (32°C)

\* ECONOMY 2 (SMART MODE) : this will lower the water temperature to 90°F (32°C) when it is not being used, and raise the water temperature back to normal level during the time of use.  
It takes about 4 days for the unit to “learn”, and “remember”, the usage pattern of the user(s)

### • NOZZLE CLEANING (Automatically)

- This product has an automatic nozzle self-cleaning function that cleans the nozzle before and after each use.

### • NOZZLE CLEANING (Manual)

- Nozzle can be cleaned manually by pressing “Posterior Wash” (POSTERIOR / FEMININE) button for 3 seconds while the seat is not occupied; the nozzle will come out without spraying water.  
After cleaning the nozzle, Press “Stop” (STOP, STOP) button to return nozzle to stand-by mode.  
(POSTERIOR, FEMININE : in Simple Operation panel –Remote Model)

### • CHIME SOUND ON/OFF SET

- While sitting on the seat, press “MOVE” (MOVE, MOVE) button for 3 seconds and you can hear the chime sound change to ON or OFF. (Remote model doesn’t have off function, BB-1000)

## 6 INSTALLATION



### CAUTION BEFORE INSTALLATION

- Do not connect to electricity before water connection.
- If you need an electric power system or extension, please consult a qualified electrician.

### STEPS

- 1** Shut off the water supply to the toilet cistern. Drain the cistern completely by flushing the toilet. Disconnect the water supply hose/pipe from the cistern.

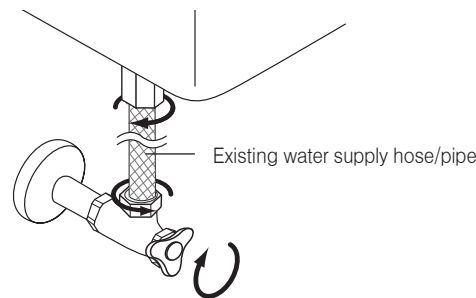

- 2** Removing the existing seat and lid.
- Release the nuts on both sides of existing toilet seat to remove the seat and lid.



- 3** Connect the tee to the cistern. Connect the check valve supplied to the tee and the 1/2" male-male adaptor to the check-valve. Connect water supply to the tee using supplied hose if required. An approved check valve must be installed on the inlet connection to the bidet seat.

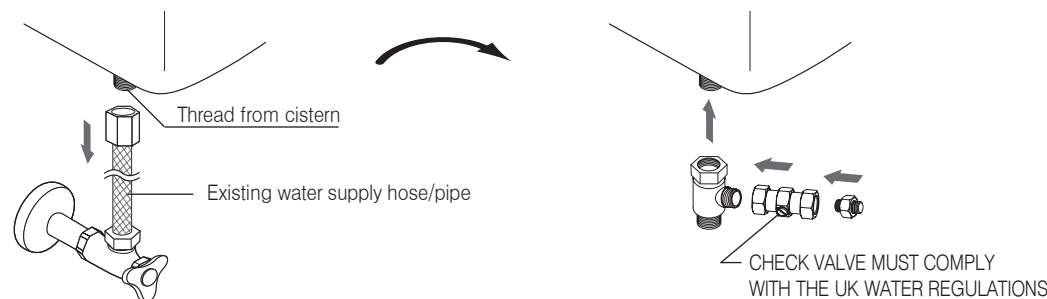

※Check for any water leaks. (TEFLON tape is strongly recommended around threads to help prevent leakage)

- 4** Installation Base Assembly.

1. Put the 2 Bolts into the 2 Installed Bolt Cases
2. Place this Bolt assembly into the Installation Base as shown.
3. Guide Arrows on the Installation Base should face up and towards the Toilet Tank.
4. Place the Installation Base and guide the Bolts into the 2 holes on the toilet bowl.

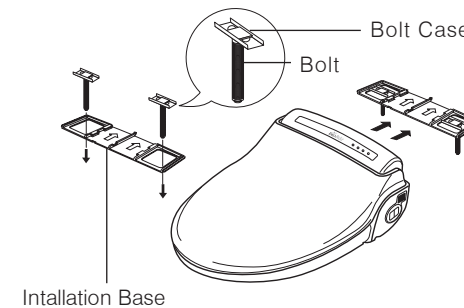

- 5** Bolt and Nut Assembly.

1. Fit the cone packing onto the bolts from below the toilet bowl as shown.
2. Loosely tighten nuts by hand.

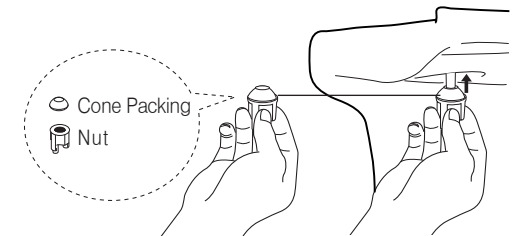

- 6** Bio Bidet Shower Toilet Seat Assembly.

1. Slide the seat onto the installation Base centering the unit with the guide arrows on the Base.
2. You will hear a click once the seat is securely mounted to the Installation Base.
3. The seat will feel a little loose on the toilet bowl. Adjust the fit from front to back and side to side for balance.
4. Tighten the nuts on both bolts securely.

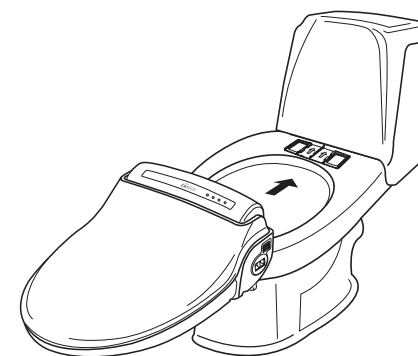

- 7** Water Supply Tube Assembly.

1. Connect the flexible tube from male-male Adaptor to the seat.
2. Open the water valve.
3. Check for leaks.
4. If there are no leaks and the surrounding area is clean and dry, connect the power cord to a ground protected power outlet.

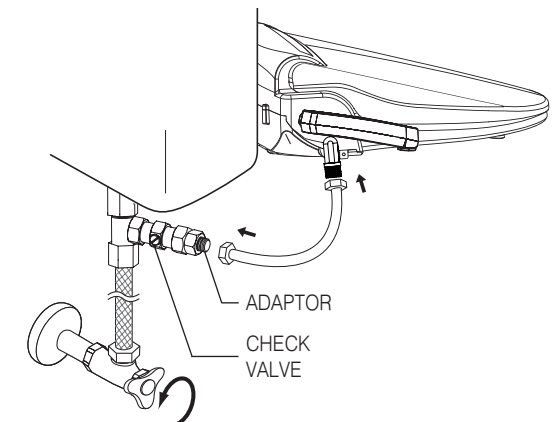

※ Customers should use the new hose set provided with the product. Do not use used set again.

※Check for any water leaks. (TEFLON tape is strongly recommended around threads to help prevent leakage)

## 6 INSTALLATION

- 8 Deodorizer Installation.**  
Insert deodorizer assembly into the unit.  
(BB-900 / 1000 Models)

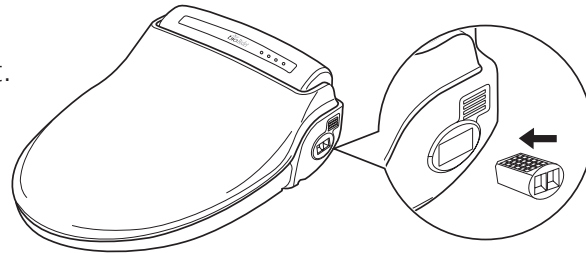

- 9 Installation of Remote Control on wall or convenient surface. (BB-1000)**



1. Peel off backing from adhesive tape on remote control bracket and fix bracket in desired position.

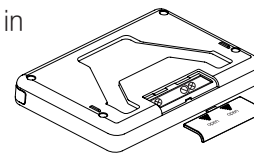

2. Slide remote control onto bracket.

Insert supplied batteries and close battery cover

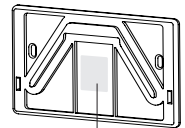

Adhesive Tape

**bioBidet**

## 7 SEPARATION OF UNIT FROM THE TOILET BOWL

- 1 Switch off power supply.
- 2 Shut off the Water Supply Valve.
- 3 Push the button on the right side of the unit to completely drain the water from water tank.
- 4 Separate the unit from toilet as shown below.

• When you pull the unit while pushing the drain button, the unit will separate from the installation base.



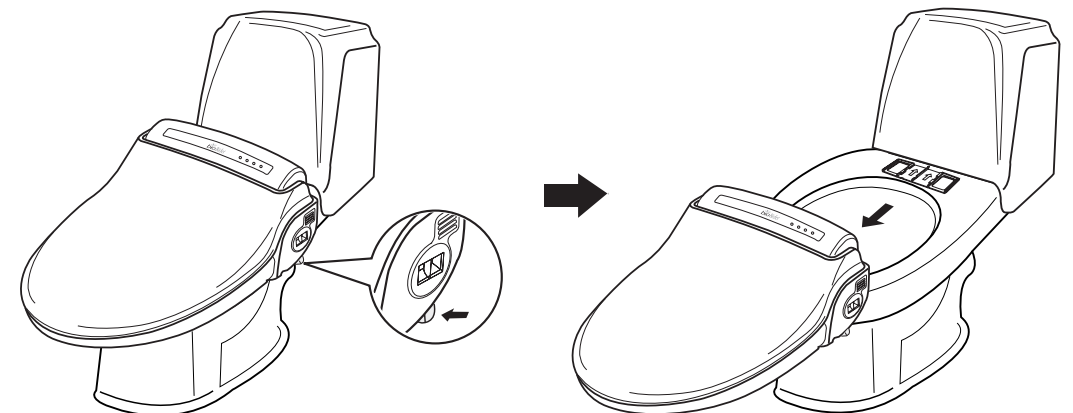



**⚠ Do not turn unit upside down.**





## 8 MAINTENANCE

### ● CLEANING THE NOZZLE

- When the “Posterior Wash (  /  )” button is pressed for 3 seconds without occupying the seat, the nozzle can be cleaned with a soft toothbrush.  
(  : in Simple Operation panel –Remote Model)
- After cleaning the nozzle, push the “Stop (  ,  )” button once and the nozzle retracts itself.  
(  : in Simple Operation panel –Remote Model)

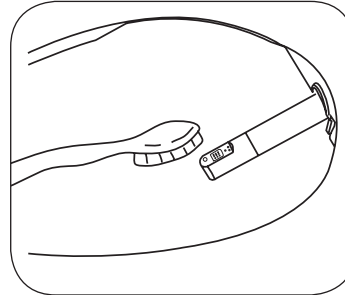

### ● CLEANING THE BODY OF UNIT

- When you clean this product, do not use “thinner” , “benzene” or toilet bowl cleaner. It may cause damage to the surface of unit.
- Use a wet cloth when you clean this product.
- Do not spray water directly on to this product.
- When you clean this product, switch off power supply.

### ● CLEANING THE STRAINER

This product will not operate properly if the strainer is clogged. Please clean the strainer regularly.

- 1) Close the water shut off valve.
- 2) Flush the toilet to empty the water reservoir.
- 3) Unscrew the water hose nut.
- 4) Clean the strainer with a small brush or water
- 5) Re-screw the water hose nut.
- 6) Open the water shut off valve.

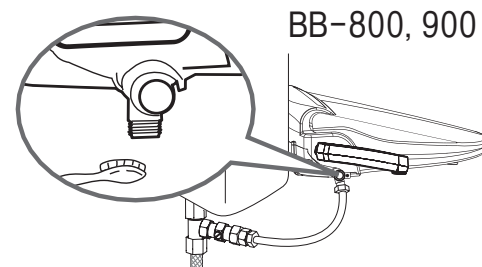
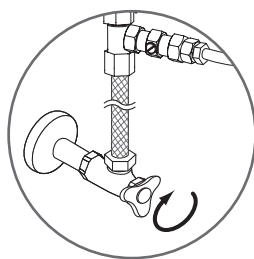

BB-800, 900

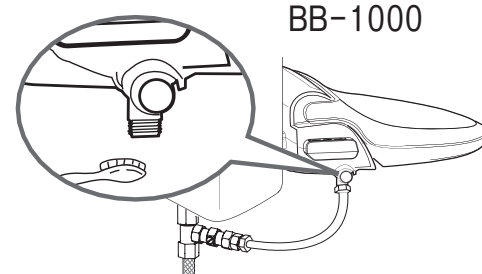

BB-1000

## 9 WATER DRAINING

### ● DRAINING THE WARM WATER TANK IN THE UNIT

If you do not intend to use this product for 14 days or longer, drain the water from the product warm water tank.

- 1) Switch off power supply.
- 2) Close the water shut off valve.
- 3) Press the drain lever until the water is completely drained from the unit's water tank.
- 4) To operate turn on water supply before switching on power supply.

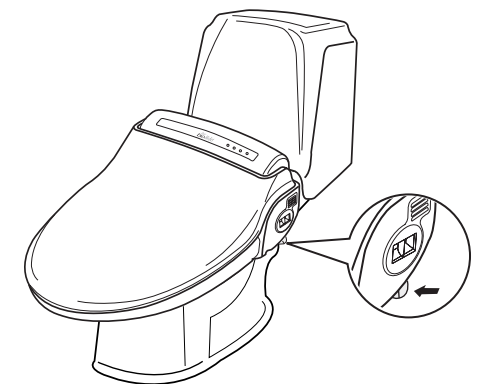
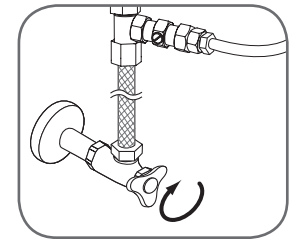

Do not drink the drained water.  
Do not insert finger into the drain hole.  
Before draining, switch off power and wait 30 minutes until the unit has cooled down.

## MAINTENANCE FOR WINTER SEASON

- 1 Check the power is ON or OFF.
- 2 Keep the water temperature on “Middle or High Level” to prevent water from freezing.
- 3 If you do not intend to use the unit for 14 days or longer, switch the power off and drain the water.



10 TROUBLE SHOOTING

Trouble	Cause	Remedy
The washing water does not spray	1.The water tank is not filled. 2.The shut off valve is closed. 3. Freezing inside the main unit or the water supply pipe.	1.Wait about one minute. Press the desired washing button once again. 2.Turn on the shut off valve. 3.Heat the room (for about two hours). Operating the unit while parts are frozen will cause a malfunction.
The unit is not operating	1.Power is switched off. 2.The seat is not occupied. 3.The battery of remote controller is exhausted. (Only BB-1000 model)	1.Switch power on. Check the power supply system in your house. 2.Occupy the seat (The unit has an occupied sensor). 3.Replace the battery.
Water is leaking	1.Faulty connection 2.Faulty unit	1.Fix connections. 2.If water is leaking from the main unit, call the service center or the place you purchased.
The washing water pressure is weak	1.The water pressure level is set to "LOW". 2.The strainer is clogged.	1.Set the water pressure to "HIGH". 2.Clean the strainer.
The washing water is not warm	1.The water temperature is set to "LOW". 2.Continuous operation has depleted the supply of warm water.	1.Set the water temperature to "HIGH". 2.Wait about three minutes.
The seat and dryer is not warm	1.The seat & dryer temperature is set to "LOW".	1.Set the seat & dryer temperature to "HIGH".

11 SPECIFICATIONS

\*The design and function of this product could be changed without notice for the improvement of its quality.

Specification		BB-800	BB-900	BB-1000
Power Rating		Australia or Europe: 220 – 240V~, 50/60Hz , 600 – 700W America or Canada: 120Vac, 60Hz, 660W		
Water inlet type	Type	Direct Inlet flow type		
	Water inlet pressure	0.04 ~ 0.74MPa(0.4 ~ 7.5 kgf/cm <sup>2</sup> )		
Power cord		(1.2m (4 feet): AMERICA) / (1.8m:Australia or Europe)		
Wash Device	Posterior Wash	Max. 1.2 ℓ /min ( Max. 0.32 GPM )		
	Feminine Wash	Max. 1.2 ℓ /min ( Max. 0.32 GPM )		
	Water Pressure Adjustable	5 Levels		
	Warm Water Temperature	Room Temp – Low, Normal, High		
	Heater	600 W		
	Safety Devices	Thermal fuse, Thermal switch, Float switch		
Heated Seat	Temperature	Room Temp – Low, Normal, High		
	Heater	55 W		
	Safety Device	Thermal fuse		
Warm Air Dryer Device	Adjustable Dry Temperature (Room Temp~45℃)	○	○	○
	Heater (250W)			
	Safety Device (Thermal fuse, bimetal)			
Turbo& Enema Function		○	○	○
Deodorizer		–	○	○
Remote control		–	–	○
Inlet water temperature		3℃~ 35℃ ( 37.4°F ~ 95°F )		
Ambient Temperature		3℃~ 40℃ ( 37.4°F ~ 104°F )		
Dimensions		Elongated(Control)	Round (Control)	Elongated (Remote)
		W : 475mm (18.7 inch) L : 525mm (20.6 inch) H : 185mm (7.28 inch)	W : 475mm (18.7 inch) L : 493mm (19.4 inch) H : 185mm (7.28 inch)	W : 456mm (17.9 inch) L : 525mm (20.6 inch) H : 185mm (7.28 inch)
Weight (kg)		5.3kg	5.4kg	5.2kg

12 WARRANTY

PDS Hygiene One Year Limited Warranty

- 1. All Our products are warranted to be free from manufacturing defects under normal use and service for a period of one (1) year from date of purchase. This warranty is extended only to the ORIGINAL PURCHASER. This warranty does not affect your statutory rights as a consumer.
- 2. Our obligations under this warranty are limited to repair or replacement, at our option, of products or parts found to be defective, provided that such products were properly installed and used in accordance with instructions. We reserve the right to make such inspections as may be necessary in order to determine the cause of the defect. We will not charge for labour, parts or carriage in connection with warranty repairs or replacements. We are not responsible for the cost of removal or reinstallation of the products.
- 3. This warranty does not apply to the following items:
  - a. Damage or loss sustained in a natural calamity such as fire, earthquake, flood, electrical storm etc.
  - b. Damage or loss resulting from any unreasonable use, misuse, abuse, negligence or improper maintenance of the product.
  - c. Damage or loss resulting from removal, improper repair or modification of the product.
  - d. Damage or loss resulting from sediments or foreign matter contained in a water system.
  - e. Damage or loss resulting from improper installation or from installation of a unit in a harsh and/or hazardous environment.
- 4. This written warranty is the only warranty made by us. Repair or replacement as provided under this warranty shall be the exclusive remedy available to the purchaser. We shall not be responsible for loss of the product or for other incidental, special or consequential damages or expenses incurred by the purchaser, or for labour or other costs due to installation or removal, or costs of repairs by others, or for any other expense not specifically stated above. Except to the extent prohibited by applicable law, any implied warranties, including that of merchantability or fitness for use, are expressly limited to the duration of this warranty.

**Note :** We will not be responsible or liable for any failure of or damage to this plumbing product or product component caused by either chloramines in the treatment of public water supply or in-tank bowl cleaners containing chlorine (calcium hypochlorite). The use of high concentration of chlorine or chlorine related products could seriously damage the fittings. This damage can cause leakage and serious property damage.

To obtain repair service under this warranty, you must first contact us in writing (see Contact Details below) to obtain a Return Merchandise Authorisation (RMA) and return instructions.

Contact Details

Post : PDS Hygiene, Greyfriars, Greyfriars Close, Old Catton, Norwich, Norfolk NR6 7DX  
Tel : 01603 426700  
Fax : 0871 781 8428  
E-mail : info@pdshygiene.com

13 INFORMATION TO THE USER

This equipment has been tested and found to comply with the limits for a Class B digital device, pursuant to part 15 of the FCC Rules. These limits are designed to provide reasonable protection against harmful interference in a residential installation. This equipment generates, uses and can radiate radio frequency energy and, if not installed and used in accordance with the instructions, may cause harmful interference to radio communications. However, there is no guarantee that interference will not occur in a particular installation. If this equipment does cause harmful interference to radio or television reception, which can be determined by turning the equipment off and on, the user is encouraged to try to correct the interference by one more of the following measures:

- Reorient or relocate the receiving antenna.
- Increase the separation between the equipment and receiver.
- Connect the equipment into an outlet on a circuit different from that to which the receiver is connected.
- Consult the dealer or an experienced radio/TV technician for help.

WARNING

Changes or modifications not expressly approved by the manufacturer could void the user's authority to operate the equipment.  
Note : The manufacturer is not responsible for any Radio or TV interference caused by unauthorized modifications to this equipment. Such modifications could void the user's authority to operate the equipment.

WARRANTY REGISTRATION

To ensure your warranty protection you must complete and return this card along with a copy of your receipt to PDS Hygiene within 30 days after Date of Purchase.

Model \_\_\_\_\_ Serial Number # \_\_\_\_\_  

Purchaser

 \_\_\_\_\_ Date of Purchase \_\_\_\_\_  
\_\_\_\_\_  
company \_\_\_\_\_  
Address \_\_\_\_\_  
City \_\_\_\_\_ Country \_\_\_\_\_  
Phone \_\_\_\_\_ E-mail \_\_\_\_\_  

Dealer(Company)

 \_\_\_\_\_  
\_\_\_\_\_ Dealer Code \_\_\_\_\_  
Address \_\_\_\_\_

MAIL TO :  
PDS Hygiene  
GREYFRIARS  
GREYFRIARS CLOSE  
OLD CATTON  
NORWICH  
NORFOLK NR6 7DX  
Telephone: +44(0)1603 426700  
Fax: +44(0) 800 014 8670  
E-mail : info@pdshygiene.com  
Web : www.pdshygiene.com

[www.biobidet.com](http://www.biobidet.com)

**DISTRIBUTOR**

**PDS Hygiene**

Greyfriars, Greyfriars Close, Old Catton,  
Norwich, Norfolk NR6 7DX

Telephone: +44(0)1603 426700

Fax: +44(0) 800 014 8670

E-mail : [info@pdshygiene.com](mailto:info@pdshygiene.com)

[www.pdshygiene.com](http://www.pdshygiene.com)